

# PROJECT UPDATE

Issue No. 7  
March 2015

## New Elementary School



Area A steel and grade beam reinforcement awaiting installation.



Installing underslab plumbing and grade beams.

### Progress in the last 30 days:

1. Primary & secondary underslab electrical conduits have been run.
2. Continued installing the building grade beams and site paving.
3. Structural steel has begun to arrive on site; high framing for Area A has been erected.
4. Underslab plumbing for Area D restrooms has been completed.
5. Continued processing shop submittals and contracting with subcontractors.

### Scheduled for the Next 30 days:

1. Continue installing the underslab plumbing and electrical rough-in work.
2. Continue installing the building grade beams and site paving.
3. Prep Area A for pouring slab.
4. Continue processing shop submittals.
5. Finalize contracting with subcontractors.

■ GMP Money Authorized to Date  
■ Completion of Project  
■ Schedule for Project

		Date of Substantial Completion
	25,845,400	100%
		12/31/15
		12/15
		11/15
		10/15
		09/15
		08/15
		07/15
		06/15
		05/15
		04/15
		03/15
		02/15
		01/15
		12/14
	11/14	
	10/14	
	09/14	
	08/14	
	07/14	
\$3.0M	12%	



*Silsbee I.S.D.*



# PROJECT UPDATE

FLOOR PLANS

New Elementary School

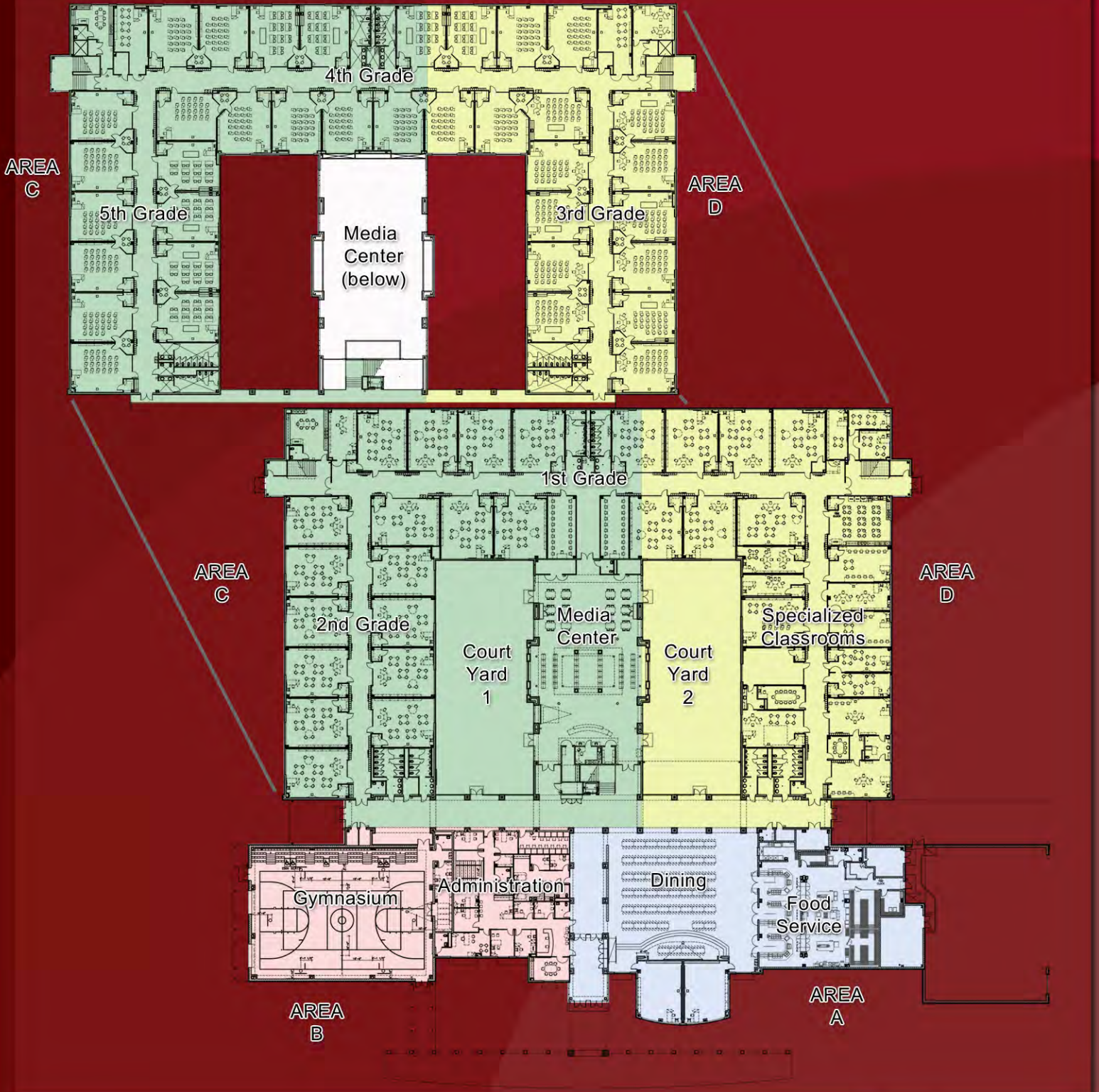

*Silsbee I.S.D.*



CLAYCOMB  
ASSOCIATES, ARCHITECTS