

# PROJECT UPDATE

Issue No. 9  
May 2015

## New Elementary School



Installing grade beam at classroom area.



Forming grade beam at food service area.



Continued receiving and erecting steel structure and roof drain piping.

### Progress in the last 30 days:

1. Continued installing the underslab plumbing and electrical rough-in work.
2. Continued erecting steel in areas 'A' and 'B'.
3. Formed and poured grade beams and slab at area 'B' (gymnasium).
4. Formed and poured grade beams at the service yard.
5. Continued processing shop submittals.

### Scheduled for the Next 30 days:

1. Finish installing the underslab plumbing and electrical rough-in work.
2. Finish first floor slab and grade beams at areas 'C' and 'D'.
3. Erect steel at areas 'C' and 'D'.
4. Begin second floor slab.
5. Begin exterior wall framing.
6. Begin masonry work.
7. Continue processing shop submittals.

		Date of Substantial Completion
25,845,400 \$5.2M	100% 21%	12/15
		11/15
		10/15
		09/15
		08/15
		07/15
		06/15
		05/15
		04/15
		03/15
		02/15
		01/15
		12/14
11/14		
10/14		
09/14		
08/14		
07/14		

- GMP Money Authorized to Date
- Completion of Project
- Schedule for Project



*Silsbee I.S.D.*



# PROJECT UPDATE

FLOOR PLANS

New Elementary School

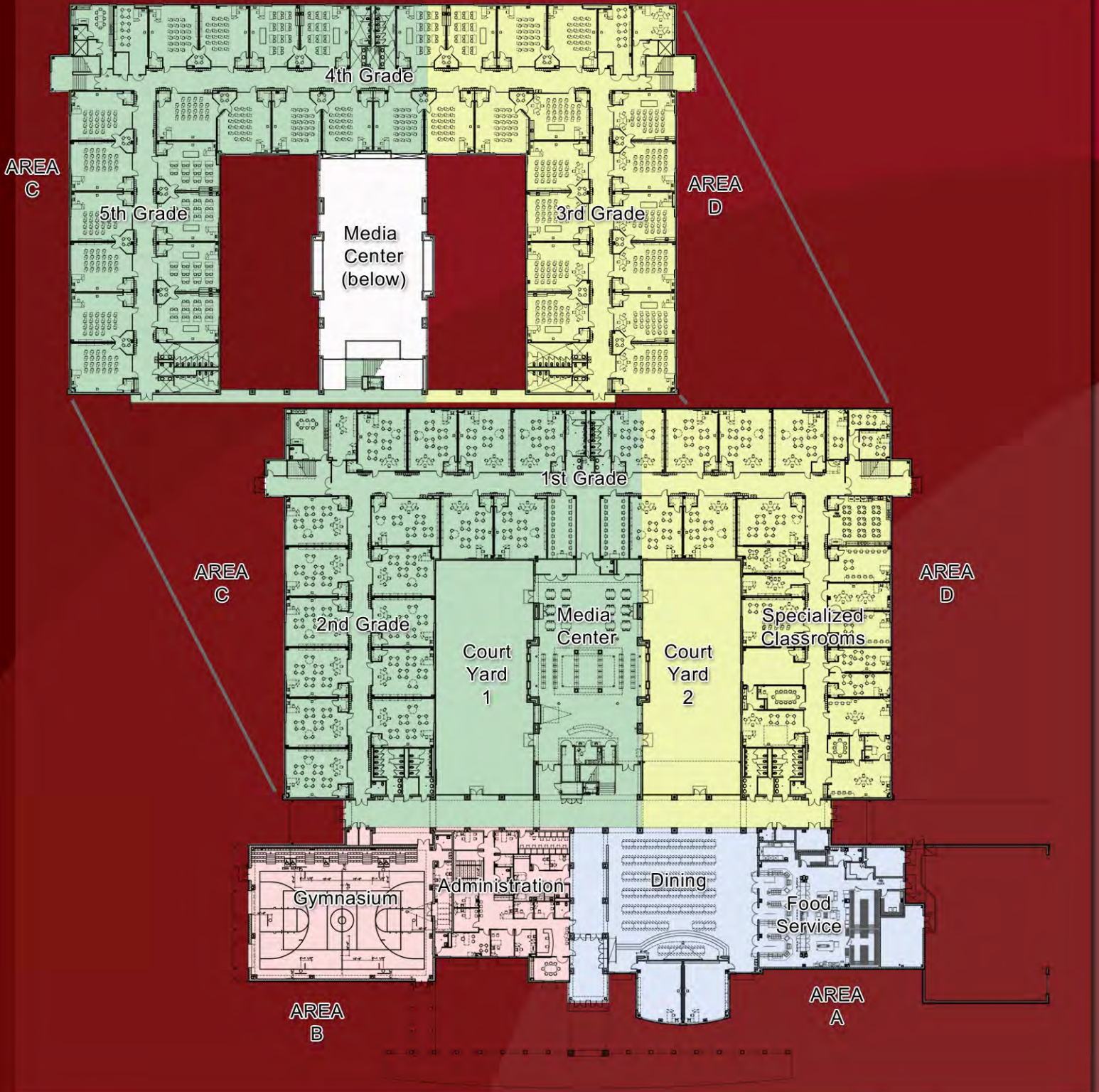

*Silsbee I.S.D.*



CLAYCOMB  
ASSOCIATES, ARCHITECTS